



JONES POTTS TAYLOR



105 Prosperity

Astley, Tyldesley, M29 7NF

£1,250 PCM

JonesPottsTaylor are pleased to present TO LET this extended, two bedroom, cottage-style, end terrace property. Situated in the sought-after residential location of Astley, close to schools, network and transport links, shops and amenities. The property briefly comprises of; entrance porch, an open plan style living room / dining room with French doors opening to the rear garden and kitchen. To the first floor are two well-proportioned bedrooms and a Jack 'N' Jill shower room with three piece suite. Outside to the front is an open stoned garden, whilst to the rear sits a patio terrace and detached garage with an access way through the centre.

Viewings will be required and under a block viewing schedule.

Viewing

Please contact our Jones Potts Taylor Office on 01942 368600 if you wish to arrange a viewing appointment for this property or require further information.



Floor Plan

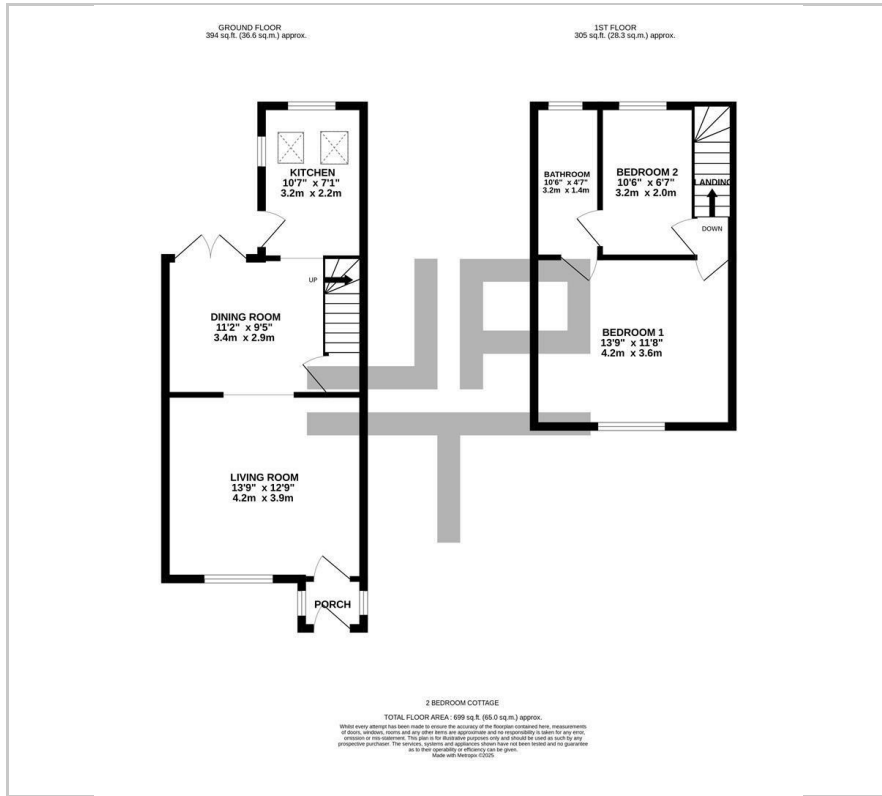

Area Map

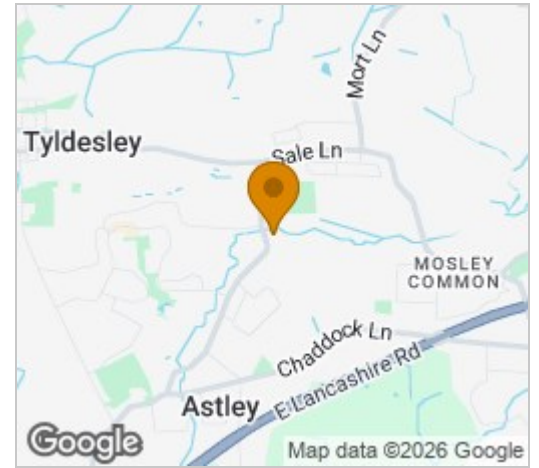

Energy Efficiency Graph

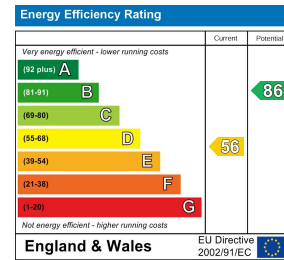

These particulars, whilst believed to be accurate are set out as a general outline only for guidance and do not constitute any part of an offer or contract. Intending purchasers should not rely on them as statements of representation of fact, but must satisfy themselves by inspection or otherwise as to their accuracy. No person in this firm's employment has the authority to make or give any representation or warranty in respect of the property.